

PARTICOLARE CANALETTA  
SEZIONE 1:20

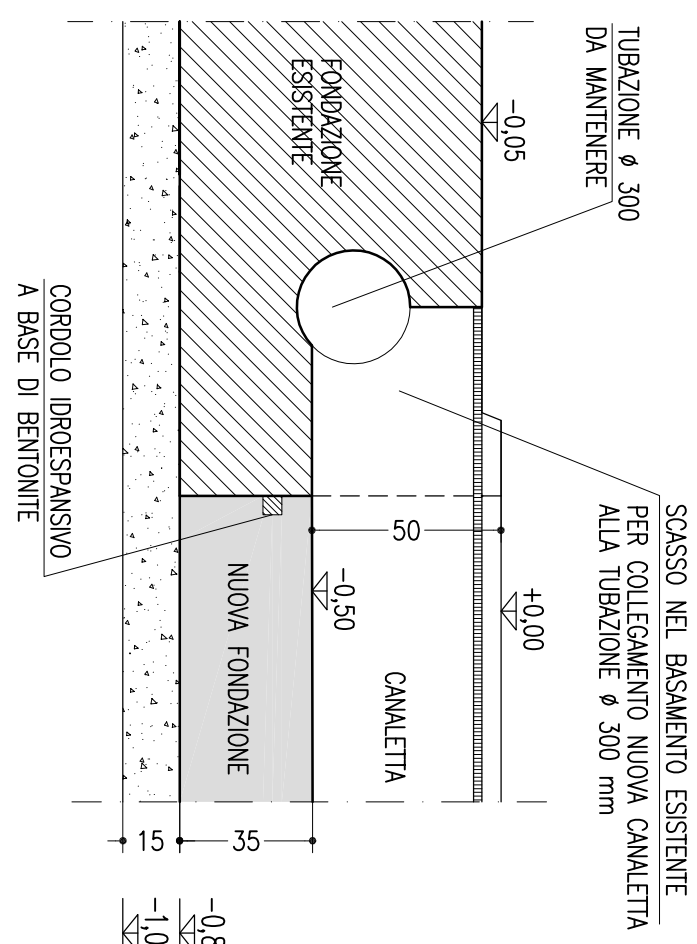

## SEZIONE U-U

CALCESTRUZZO:	C 32/40 (Rck40 MPa)
Classe di resistenza	
Classe di esposizione	XC4 + XF1
Classe di consistenza	S4
Diámetro max. aggregato	20 mm
ACCIAIO:	B450C



<b>PRANTNER</b> GmbH	Betreuung Documento 9843-707	
<b>Verfahrenstechnik</b>	<b>BASAMENTO 2 - CASSERI</b>	
Tel. 07121 9105-0/fax 910553 Tele-Glossart 97-46 Fax 07121 9105-10	Lechtungs- Nr. 105 676	Kennzahl 9843
Auftr.-Angebot-Nr. 721770	Material 150 120	Technische Änderungen vorbehalten Schutzzeitraum nach DIN 34
<b>Amplamento TAF Pieve</b>		

N.B.:  
TRACCIAMENTO GENERALE: VEDI TAVOLA s.12  
PARTICOLARI BASAMENTI TIPO F, Q: VEDI TAVOLE s.09 – s.10

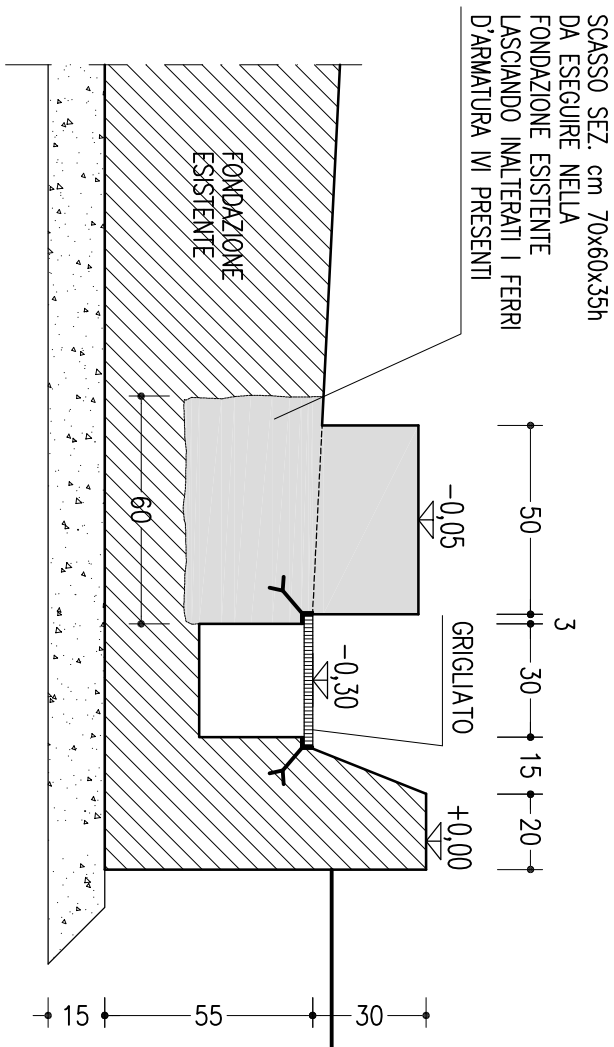
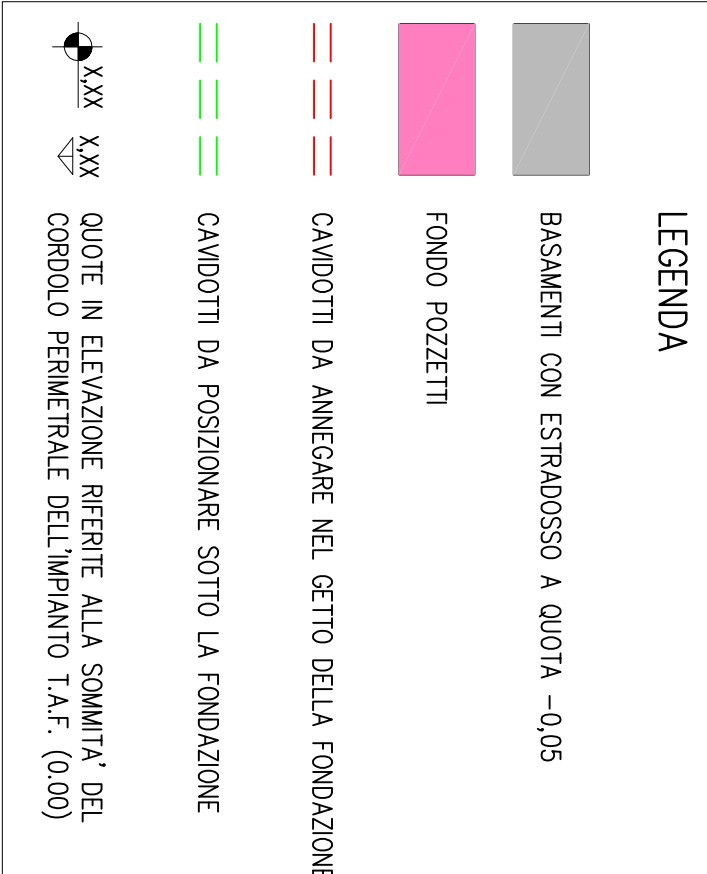

SEZIONE Z  
1:20

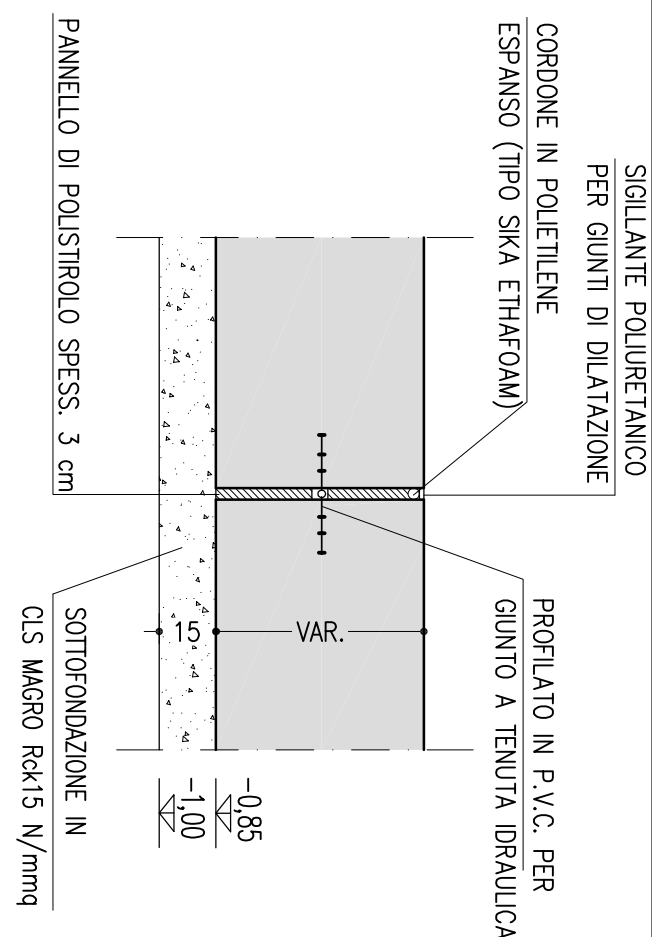

PARTICOLARE GIUNTO DI DILATAZIONE  
SEZIONE 1:20

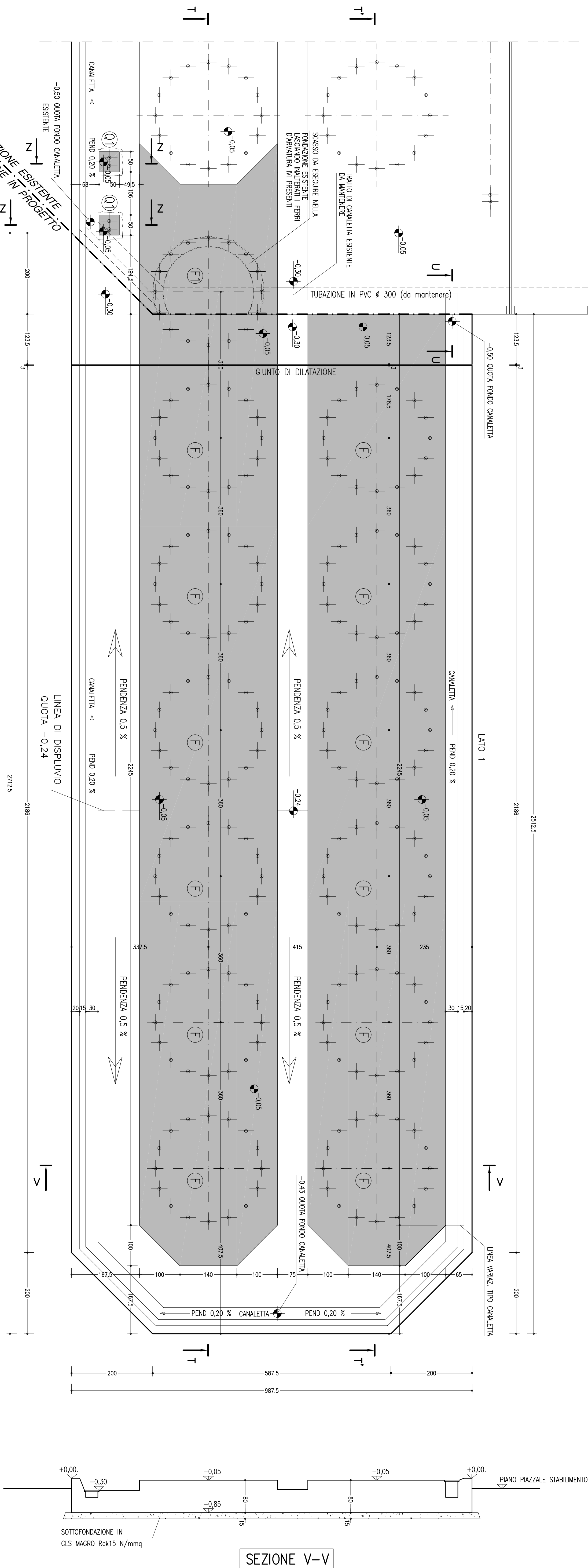

SEZIONE V-V

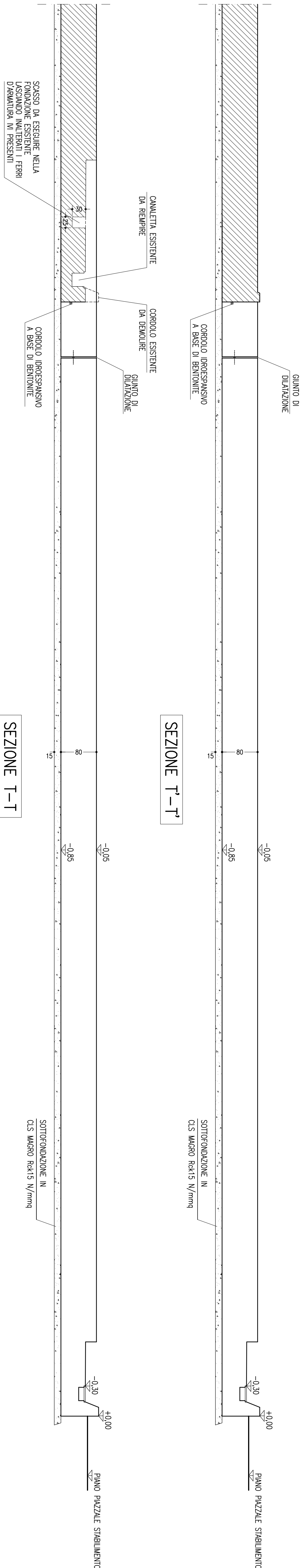

## SEZIONE T-T